

General Notes

Materials:

- Cement - CSA A5 Type HS
- Concrete Strength at 28 days - 30 Mpa
- Air Entrainment - 5-8%
- Aggregate Size (max) - 20mm
- Made to CSA A257.4 Standard
- Conforms to A.S.T.M. C478 Standard
- Reinforcing steel Yield Strength - 400 Mpa
- All Dimensions in Inches unless otherwise indicated
- All Rubber gasket material supplied by Pre-Con certified to ASTM C923

Pre-Con Ltd

3320 Idylwyld Dr. North
Saskatoon SK
Phone 306-931-9229

1		
No.	Revision/Issue	Date

Project **Commercial Splash Pan**

Date **Sept. 09 ,2015**

Drawn by:
Gerry Esau A.Sc.T.

Sheet
1/1

Scale **NTS**

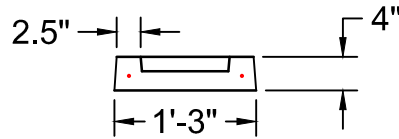

Section C-C

Dimension A Options
762mm (30")
914mm (36")
1216mm (48")
1524mm (60")
2438mm (96")
3048mm (120')

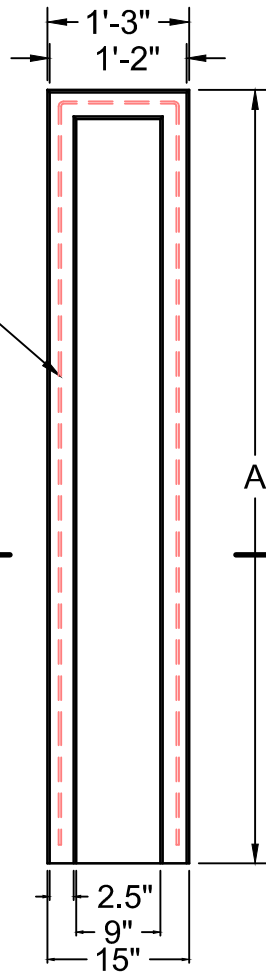

Top View

15m Bar
Continuous



A